

A Castle in the Making

Dear virtual visitors

Here at Guédelon, the year is 1244 and the gates have re-opened for what promises to be an even more action-packed 16th season; work is under way in both the East and West Towers, as well as the Great Hall. The 2013 building programme is outlined for you in this season's first edition of "A Castle in the Making". Due to popular demand we have made some changes to our opening hours; for the first time, we will be open on Wednesdays in April, May and June. We look forward to sharing our progress with you and hope to see you very soon at Guédelon.

Maryline Martin Managing Director

The Building Programme 2013

In the north range



The kitchen

The stonemasons have dressed and fixed the limestone **hearthstones*** and the masons have paved the kitchen floor; the **paving tiles** were made and fired by our tilers in the forest.

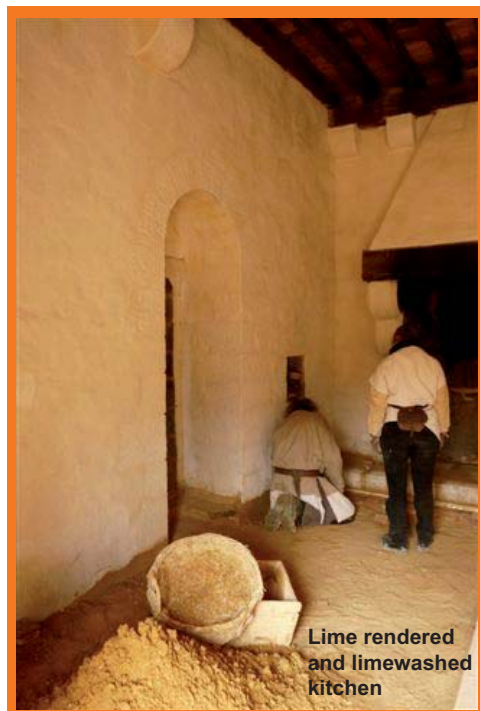

Lime rendered and limewashed kitchen

This season the woodcutters, carpenters and blacksmiths will finish the kitchen's **three doors**: the door on the eaves wall, the door on the east gable wall and the interior door leading to the storeroom. The doors will be made from cleft oak; the hinges and strap hinges will be forged on site. The walls have already been lime rendered and **limewashed**, making them altogether brighter and cleaner.

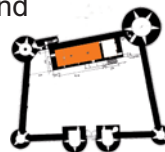

The great hall

The masons will lay oak **laths*** between the joists, which will then be covered with a beaten earth floor. Finally, paving tiles will be laid on the beaten earth floor.

The **door** leading to the antechamber will also be made this season.

Laths: short wooden strips laid on joists, on which a beaten earth floor can be laid. Also used as a groundwork for plaster on walls.

On the northern curtain wall

The **crenulated wall-walk** on the northern curtain wall is complete. For the first time, you can walk along the entire section of wall-walk leading from the Chapel Tower to the Great Tower.

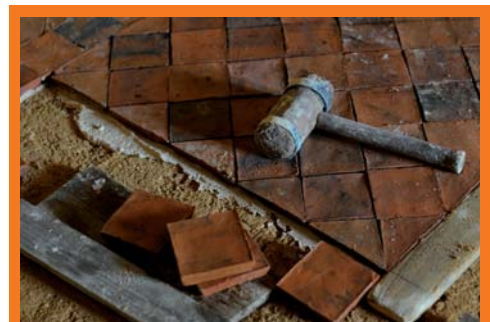

Hearthstones: stones used to form the floor of a fireplace, often extending into the room.



On the Great Tower

On the tower's 2nd floor



Throughout the season, the masons will finish building the **mural stair** leading up to the Great Tower's 2nd floor (US = 3rd floor) as well as the **vaulted corridor** leading to the octagonal chamber, and the chamber's **doorway**. The stonemasons will dress the stones for the two **windows with window seats** built into pointed arch niches.

Finally the team will build the walls of the north-west section of the **octagonal chamber**.

On the West Tower

A team of masons will continue building the western corner tower's ground-floor **guardroom**, including its three **arrow loops**. The chamber will have a wooden ceiling.



On the East Tower

Another team will lay out the first-floor **guardroom**, above the domed vault built last season. The stonemasons will dress the **steps** leading to this chamber, as well as the stones for two **arrow loops**. A **wooden ceiling** will be installed above the chamber, at the same level as the wall-walk.

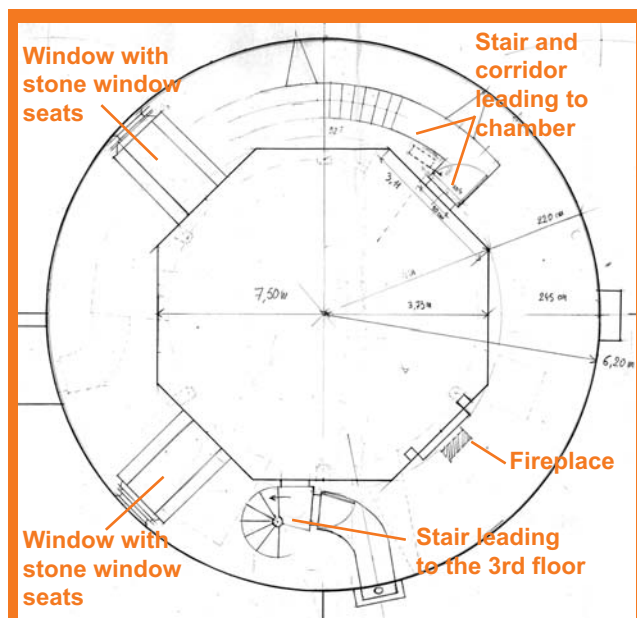

Plan of the octagonal chamber on the Great Tower's 2nd floor.

2013 upcoming events



Rendez-vous with the master-mason

A privileged encounter!

Florian Renucci, master-mason, will describe progress on the construction site, take you to otherwise inaccessible areas of the castle and hold a question and answer session.

Please consult our website for upcoming dates.



Iron smelting in a bloomery furnace

Throughout the day, next to the site's forge, watch the blacksmiths smelting iron ore from Guédelon in a bloomery furnace.

Upcoming dates: **Sunday 26th May and Sunday 16th June**

Demonstration included in the entrance fee



Demonstration of medieval cuisine

In the castle kitchen, the smell of baking bread wafting from the oven in the fireplace and chicken roasting on the spit, Dame Françoise will share her passion for medieval cooking.

Upcoming dates: **8th – 11th May, 18th – 20th May, 29th – 30th June, 12th – 15th July, 19th – 21st July, 9th – 11th August, 15th – 18th August**

Demonstration included in the entrance fee

Recently published: ***L'authentique cuisine du Moyen Âge***

Written by Françoise de Montmollin; photos by François Folcher.

RRP: €24, available from our online gift shop (only available in French).

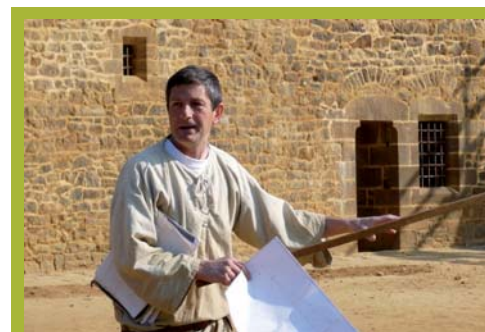

Don't miss out on receiving our newsletter, "A Castle in the Making"!

In order to improve the quality of our communication with you, we are changing the system for distributing our newsletters. If you wish to continue receiving your free newsletter, please renew your inscription on our website's home page: www.guedelon.fr Thank you!